



Cable Replacement from Mark Island to Mink Island

During maintenance work, it was discovered that the neutral wire of the submarine cable feeding from Mark Island to Mink Island was deteriorating and the entire run of cable will need to be replaced.

The cable originates on Mark Island at pole 11528/17 located on property on Gilford Tax Map 245, Lot 8 owned by Richard Melvin and is buried approximately 34 feet underground before entering the lake bed, where it travels approximately 560 feet to the shore of Mink Island and onto the property of Joanna Pike and Greg Dickinson, Tax Map 245, Lot 29 where it is buried approximately 100 feet to a vault (11528/18).

RIGHT OF EASEMENT

13720

I/we Richard I. Emerson, Trustee of Laconia

State of New Hampshire (Unmarried) (Husband and Wife) for consideration paid, grant to the New Hampshire Electric Cooperative, Inc., a New Hampshire corporation and

the Telephone Company, a corporation, their respective successors and assign forever, with warranty covenants, the RIGHT and EASEMENT to construct, repair, operate, maintain, patrol, replace and remove overhead and underground lines, consisting of wires, cables, ducts, poles and other apparatus necessary for the transmission and distribution of electricity and/or telephone service on, over and under my/our land in the city/town of Gilford

County of Belknap, New Hampshire, more particularly described as follows:

Land on the Southern side of North Island, bounded northerly by land of Elewelle, southerly by land of McPherson, easterly by land of Lake Winnepesaukee, and westerly by land of the said Lake

11528/17

This conveyance shall include the right to clear and keep clear a right-of-way of all trees and underbrush by such means as the grantees may select.

The location of said right-of-way shall be determined by mutual consent and become permanent upon the installation of said lines.

The width of the right-of-way clearing shall not exceed feet. Necessary guy wires, and anchors may be located beyond the cleared area.

The grantor shall continue to enjoy use of the property for any purposes not adverse to the grantee's rights. Planting of trees, building of structures or storage of lumber and/or other materials within the granted right-of-way shall not be undertaken without the grantee's knowledge and consent. The grantee agrees to make reasonable modification of the lines within the grantor's property at the grantor's expense to accommodate future needs of the grantor in the use of his property.

The grantor (s) release to the grantee (s) all rights and dower/curtesy, homestead and other interests in the rights and easements hereby conveyed.

Witness my/our hand (s) and seal (s) this 30 day of April, 1974

WITNESSES: David M. Gifford

GRANTORS SIGNATURES: Richard I. Emerson, Trustee
for Richard I. Emerson
Emerson

FILED
David M. Gifford
1974 JUL -5 AM 9:35
REGISTRY OF DEEDS
BELKNAP COUNTY

STATE OF NEW HAMPSHIRE
County of Belknap

On this 30 day of April, 1974, before me the undersigned officer, personally appeared Richard I. Emerson known to me (or satisfactorily proven) to be the person(s) whose name(s) Emerson subscribed to the within instrument and acknowledged that he executed the same for the purpose therein contained.

In witness whereof I hereunto set my hand and official seal.

BK- 635 PGE-423

David M. Gifford
Notary Public - Justice of the Peace
My commission expires April

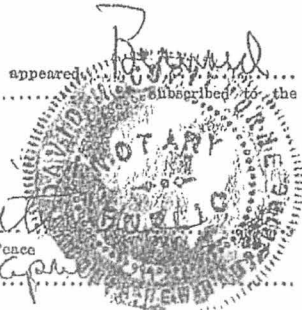

"CONSIDERATION LESS THAN \$100"

EXHIBIT B

Judith A. McHath

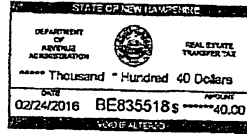

Right of Easement

W.O. # 22689977

I/We JOANNE T PIKE & GREGORY M DICKINSON
of PO BOX 7262, LACONIA

State of NEW HAMPSHIRE 03246 (unincorporated) (husband and wife) (hereinafter "Grantor")
for consideration paid, grant to the NEW HAMPSHIRE ELECTRIC COOPERATIVE, INC., 579 TENNEY
MOUNTAIN HIGHWAY PLYMOUTH, NEW HAMPSHIRE 03264, a New Hampshire corporation, and
NORTHERN NEW ENGLAND TELEPHONE OPERATIONS LLC d/b/a FairPoint Communications - NNE, a
limited liability company organized under the laws of the State of Delaware, having a place of business at 100 Gay
Street, Manchester, New Hampshire, 03103; their respective successors and assigns forever (hereinafter "Grantee")
with warranty covenants, the RIGHT and EASEMENT to construct, repair, operate, maintain, patrol, replace and
remove overhead and underground lines consisting of wires, ducts, cables, poles, and other apparatus necessary for
the transmission and distribution of electricity and/or telephone service on, over and under my/our land in New
Hampshire,
More particularly described in deed recorded in Registry of Deeds at Book 1486 Page 306-308

Land in the city/town of GILFORD County of BELKNAP New Hampshire

On the WEST side of MINK ISLAND

This conveyance shall include the right to clear and keep clear a right-of-way of all trees and underbrush by
such means as the grantee may select and to cut down from time to time all dead, weak, leaning or dangerous
trees that may exist outside of the right of way, but are tall enough to strike the wires in falling. The location
of said right-of-way shall be determined by mutual consent and become permanent upon installation of said
lines.

The width of right-of-way shall not exceed 15 Ft. each side of pole and/or ditch line. Necessary guy wires and
anchors may be located beyond the cleared area.

In the event it becomes necessary to disturb the pavement/landscaping above underground conductors for
maintenance purposes the grantor(s), directors, successors or assigns will be responsible for the same.

The grantor shall continue to enjoy use of the property for any purpose not adverse to the grantee's rights.
Planting of trees, building of structures or storage of lumber and/or other materials within the granted right-
of-way shall not be undertaken. The Grantee agrees to make reasonable modification of the lines within the
grantor's property at the grantor's expense to accommodate future needs of the grantor in the use of the
property.

The grantor(s) release to the grantee(s) all right, homestead and other interests in the rights and easements
hereby conveyed
Witness my/our hand(s) and seal(s) this 20th day of June 20 15

GRANTOR'S SIGNATURE
Joanne T. Pike

GRANTOR'S SIGNATURE
Gregory M. Dickinson

JOANNE T PIKE
(Printed or typewritten copy of signature)

GREGORY M DICKINSON
(Printed or typewritten copy of signature)

State of NH County of Belknap ~~This Area For Notary Use Only~~
On this 20th day of June 20 15

Before me the undersigned officer personally appeared
JOANNE T PIKE & GREGORY M DICKINSON
known to me (or satisfactorily proven) to be the person(s) whose name(s) is/are subscribed
to the within instrument that he executed the same for the purpose therein contained.
In witness whereof I hereunto set my hand and official seal.

Alex Donald
(Notary Public/Justice of the Peace)

ALEXANDER DONALD
Notary Public - New Hampshire
My Commission Expires February 2, 2016
(My commission expires)

199600

EXHIBIT C



The State of New Hampshire
DEPARTMENT OF ENVIRONMENTAL SERVICES



Thomas S. Burack, Commissioner

=====
WETLANDS AND NON-SITE SPECIFIC PERMIT 2016-02444
=====

Permittee: NH Electric Cooperative, Inc.
c/o Dean Benton
579 Tenney Mountain Hwy.
Plymouth, NH 03264
Project Location: Mark Island, Gilford
Gilford Tax Map/Lot No. 245 / 8
Waterbody: Lake Winnepesaukee

NOTE--
CONDITIONS

APPROVAL DATE: 10/26/2016 EXPIRATION DATE: 10/26/2021
=====

Based upon review of the above referenced application, in accordance with RSA 482-A and RSA 485-A:17, a Wetlands Permit and Non-Site Specific Permit was issued. This permit shall not be considered valid unless signed as specified below.

PERMIT DESCRIPTION: Impact no more than 120 sq. ft. of bed and bank to replace an existing submarine power cable, on Mark Island, on Lake Winnepesaukee, in Gilford.

THIS APPROVAL IS SUBJECT TO THE FOLLOWING PROJECT SPECIFIC CONDITIONS:

- 1. All work shall be in accordance with plans by Dean Benton dated July 25, 2016, as received by DES on August 25, 2016.
2. All development activities associated with this project shall be conducted in compliance with applicable requirements of RSA 483-B and N.H. Code of Administrative Rules Env-Wq 1400 during and after construction.
3. This permit does not authorize the removal of trees or saplings within the waterfront buffer that would result in a tree and sapling point score below the minimum required per RSA 483-B:9, V, (a)(2)(D)(iv).
4. Work authorized shall be carried out such that there are no discharges in or to spawning or nursery areas during spawning seasons. Impacts to such areas shall be avoided or minimized to the maximum extent practicable during all other times of the year.
5. Work shall be carried out in a time and manner to avoid disturbances to migratory waterfowl breeding and nesting areas.
6. Appropriate siltation and erosion controls shall be in place prior to construction, shall be maintained during construction, and shall remain in place until the area is stabilized. Temporary controls shall be removed once the area has been stabilized.
7. Appropriate turbidity controls shall be installed prior to construction, shall be maintained during construction such that no turbidity escapes the immediate dredge area and shall remain in place until suspended particles have settled and water at the work site has returned to normal clarity.
8. All dredged and excavated material and construction-related debris shall be placed outside of the areas subject to RSA 482-A. Any spoil material deposited within 250 ft. of any surface water shall comply with RSA-483-B.

EXHIBIT D-1

9. The contractor responsible for completion of the work shall use techniques described in the New Hampshire Stormwater Manual, Volume 3, Erosion and Sediment Controls During Construction (December 2008).

GENERAL CONDITIONS THAT APPLY TO ALL DES WETLANDS PERMITS:

1. A copy of this permit shall be posted on site during construction in a prominent location visible to inspecting personnel;
2. This permit does not convey a property right, nor authorize any injury to property of others, nor invasion of rights of others;
3. The Wetlands Bureau shall be notified upon completion of work;
4. This permit does not relieve the applicant from the obligation to obtain other local, state or federal permits, and/or consult with other agencies as may be required (including US EPA, US Army Corps of Engineers, NH Department of Transportation, NH Division of Historical Resources (NH Department of Cultural Resources), NHDES-Alteration of Terrain, etc.);
5. Transfer of this permit to a new owner shall require notification to and approval by DES;
6. This project has been screened for potential impacts to **known** occurrences of rare species and exemplary natural communities in the immediate area. Since many areas have never been surveyed, or have received only cursory inventories, unidentified sensitive species or communities may be present. This permit does not absolve the permittee from due diligence in regard to state, local or federal laws regarding such communities or species.
7. Review enclosed sheet for status of the US Army Corps of Engineers' federal wetlands permit.

APPROVED: _____

Dale Keirstead
DES Wetlands Bureau

=====

BY SIGNING BELOW I HEREBY CERTIFY THAT I HAVE FULLY READ THIS PERMIT AND AGREE TO ABIDE BY ALL PERMIT CONDITIONS.

OWNER'S SIGNATURE (required)

CONTRACTOR'S SIGNATURE (required)



The State of New Hampshire
DEPARTMENT OF ENVIRONMENTAL SERVICES



Thomas S. Burack, Commissioner

=====

WETLANDS AND NON-SITE SPECIFIC PERMIT 2016-02446

Permittee: Dean Benton
 c/o NH Electric Cooperative, Inc.
 579 Tenney Mtn. Hwy.
 Plymouth, NH 03264-3154

Project Location: Mink Island, Gilford
 Gilford Tax Map/Lot No. 245 / 29

Waterbody: Lake Winnepesaukee

**NOTE--
 CONDITIONS**

APPROVAL DATE: 10/26/2016 **EXPIRATION DATE:** 10/26/2021

=====

Based upon review of the above referenced application, in accordance with RSA 482-A and RSA 485-A:17, a Wetlands Permit and Non-Site Specific Permit was issued. This permit shall not be considered valid unless signed as specified below.

PERMIT DESCRIPTION: Impact no more than 120 sq. ft. of bed and bank to replace an existing submarine power cable, Mink Island, Lake Winnepesaukee, Gilford.

THIS APPROVAL IS SUBJECT TO THE FOLLOWING PROJECT SPECIFIC CONDITIONS:

1. All work shall be in accordance with plans by Dean Benton dated July 25, 2016, as received by DES on August 25, 2016.
2. All development activities associated with this project shall be conducted in compliance with applicable requirements of RSA 483-B and N.H. Code of Administrative Rules Env-Wq 1400 during and after construction.
3. This permit does not authorize the removal of trees or saplings within the waterfront buffer that would result in a tree and sapling point score below the minimum required per RSA 483-B:9, V, (a)(2)(D)(iv).
4. Work authorized shall be carried out such that there are no discharges in or to spawning or nursery areas during spawning seasons. Impacts to such areas shall be avoided or minimized to the maximum extent practicable during all other times of the year.
5. Work shall be carried out in a time and manner to avoid disturbances to migratory waterfowl breeding and nesting areas.
6. Appropriate siltation and erosion controls shall be in place prior to construction, shall be maintained during construction, and shall remain in place until the area is stabilized. Temporary controls shall be removed once the area has been stabilized.
7. Appropriate turbidity controls shall be installed prior to construction, shall be maintained during construction such that no turbidity escapes the immediate dredge area and shall remain until suspended particles have settled and water at the work site has returned to normal clarity.
8. All dredged and excavated material and construction-related debris shall be placed outside of the areas subject to RSA 482-A. Any spoil material deposited within 250 ft. of any surface water shall comply with RSA-483-B.

EXHIBIT E-1

9. The contractor responsible for completion of the work shall use techniques described in the New Hampshire Stormwater Manual, Volume 3, Erosion and Sediment Controls During Construction (December 2008).

GENERAL CONDITIONS THAT APPLY TO ALL DES WETLANDS PERMITS:

1. A copy of this permit shall be posted on site during construction in a prominent location visible to inspecting personnel;
2. This permit does not convey a property right, nor authorize any injury to property of others, nor invasion of rights of others;
3. The Wetlands Bureau shall be notified upon completion of work;
4. This permit does not relieve the applicant from the obligation to obtain other local, state or federal permits, and/or consult with other agencies as may be required (including US EPA, US Army Corps of Engineers, NH Department of Transportation, NH Division of Historical Resources (NH Department of Cultural Resources), NHDES-Alteration of Terrain, etc.);
5. Transfer of this permit to a new owner shall require notification to and approval by DES;
6. This project has been screened for potential impacts to **known** occurrences of rare species and exemplary natural communities in the immediate area. Since many areas have never been surveyed, or have received only cursory inventories, unidentified sensitive species or communities may be present. This permit does not absolve the permittee from due diligence in regard to state, local or federal laws regarding such communities or species.
7. Review enclosed sheet for status of the US Army Corps of Engineers' federal wetlands permit.

APPROVED: _____

Dale Keirstead
DES Wetlands Bureau

=====

BY SIGNING BELOW I HEREBY CERTIFY THAT I HAVE FULLY READ THIS PERMIT AND AGREE TO ABIDE BY ALL PERMIT CONDITIONS.

OWNER'S SIGNATURE (required)

CONTRACTOR'S SIGNATURE (required)

SUBMARINE CABLE

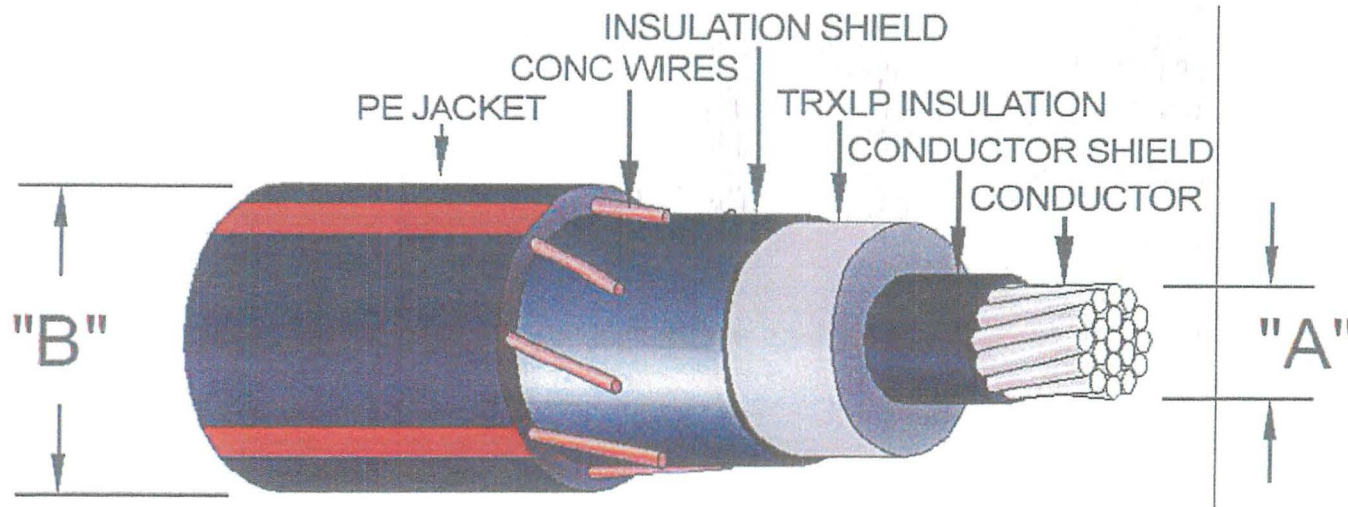

	Material #	Description	A(IN.)	B(IN.)
UW1.010.SUB	15560005	Cond, Sub 1/0 AL 15 kV	.398	1.720
ZUW1.010.SUB	15560006	Cond, Sub 1/0 AL 35 kV	-	-

EXHIBIT F



CONSTRUCTION STANDARDS
PRIMARY UNDERGROUND CABLE

UW1

ISSUE DATE: 01/06

IUSUB

MATERIALS FURNISHED AND INSTALLED BY CONSUMER

- ① 4" CONDUIT
SCHEDULE 80 PVC
- ② 4" 90° SWEEP
GALVANIZED STEEL
- ③ 4" ADAPTER
(IF NEEDED)
- ④ CONDUIT END CAPS
- ⑤ 1/4" POLYPROPYLENE STRING
INSTALLED IN ALL CONDUITS WITH STRING
EXPOSED AND TIED OFF AT ENDS THRU
CAPS AT END OF CONDUIT.

MATERIALS FURNISHED AND INSTALLED BY NHEC

- POLE
GROUND ROD AND CONNECTOR
ALUMA-FORM STANDOFF BRACKETS

STANDOFF BRACKET

TOP VIEW

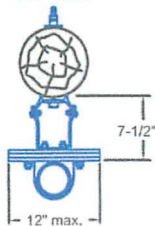

CONDUIT APPROX. 7-1/2"
FROM FACE OF POLE

STANDOFF BRACKET IMPORTANT NOTES:

CONTRACTOR SWEEPS CONDUIT TO 7-1/2" FROM FACE OF POLE.

NHEC PERSONNEL WILL PROVIDE A STANDOFF BRACKET TO ASSIST
STEEL SWEEP DISTANCE TO THE POLE.

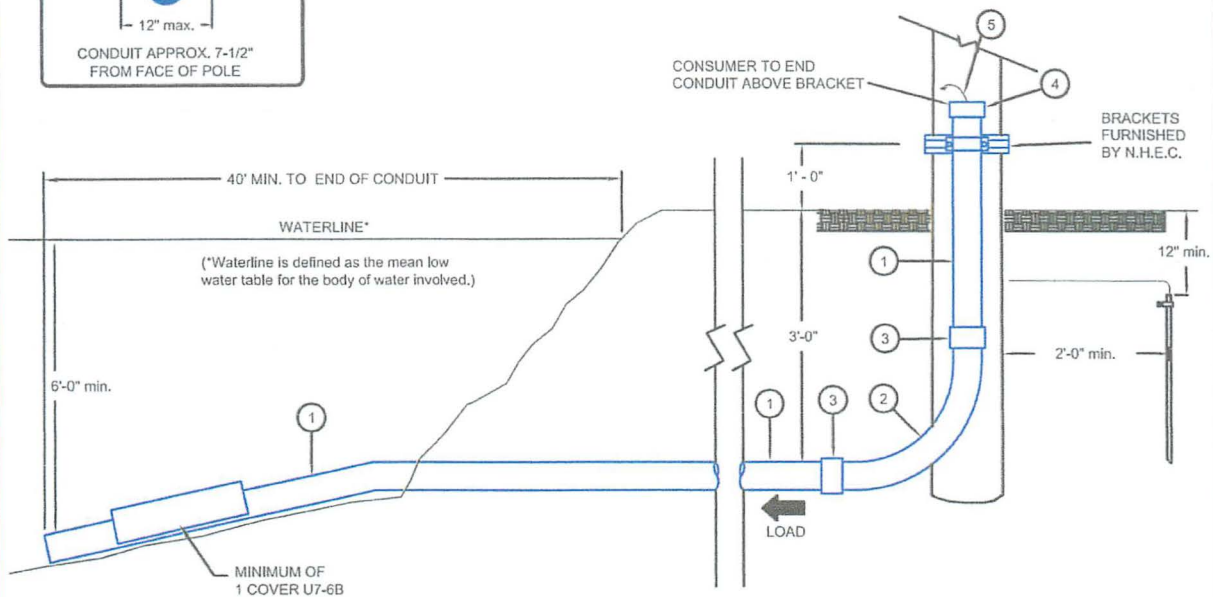

NOTES:

- 1.) ALL CONDUIT AND ACCESSORIES MUST MEET ELECTRICAL GRADE SPECIFICATIONS.
- 2.) ALL CONSUMER FURNISHED MATERIAL TO BE ON HAND, AND ALL NECESSARY EXCAVATION AND CONDUIT READY PRIOR TO TIME OF INSTALLATION OF EQUIPMENT ON POLE BY NHEC PERSONNEL.
- 3.) CONDUIT TO BE ON QUADRANT OF POLE OPPOSITE FLOW OF TRAFFIC.



CONSTRUCTION STANDARDS
UNDERGROUND PRIMARY
RADIAL FEED
PRIMARY POLE MATERIALS

IUSUB

ISSUE DATE: 01/06

EXHIBIT G

U7-6B

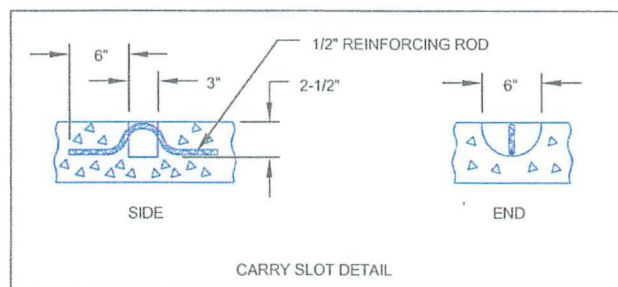
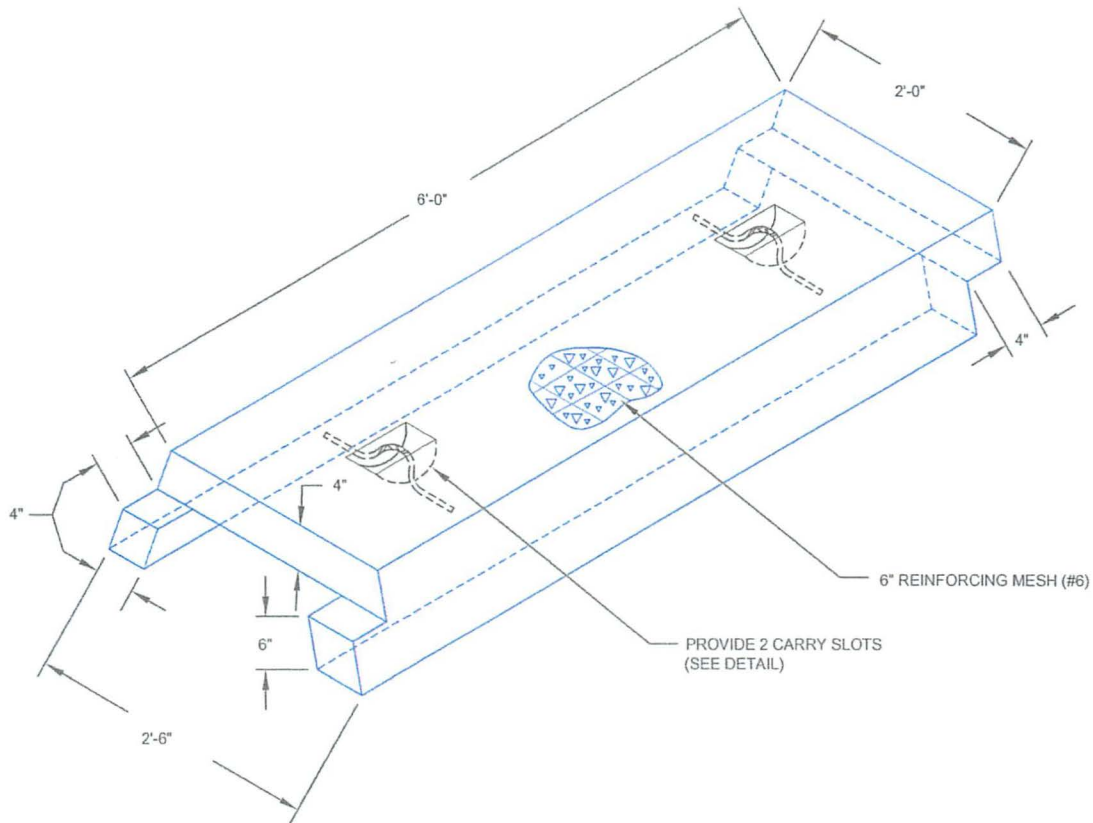

NOTE:

- 1.) CONCRETE SHALL HAVE A COMPRESSIVE STRENGTH OF 5000 P.S.I. AFTER 28 DAYS WHEN TESTED IN ACCORDANCE WITH ASTM C 39-72 (LATEST EDITION).



CONSTRUCTION STANDARDS

UNDERWATER CABLE COVER

U7-6B

ISSUE DATE: 01/06

EXHIBIT H

INSTALLATION REQUIREMENTS FOR SUBMARINE CABLES

TYPICAL CONDUIT SETUP IN WATER

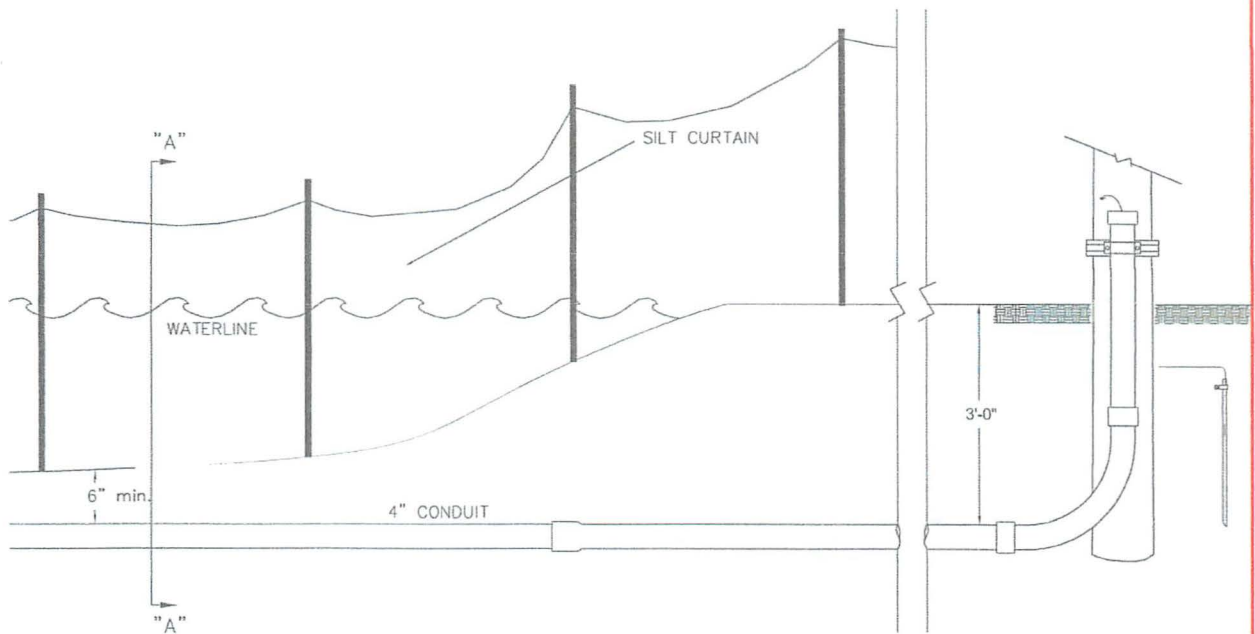
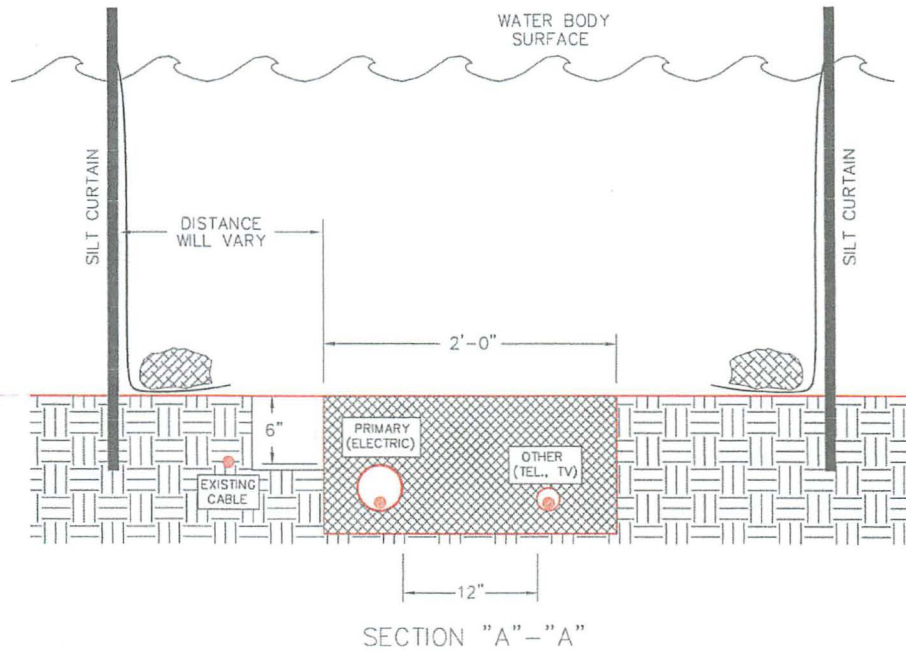

EXHIBIT I

NOTES:

- 1.) THIS CROSS-SECTION SHOWS THE 4" CONDUIT ENTERING THE BOTTOM OF THE BODY OF WATER IN A TYPICAL SETTING. THE CONDUIT WILL BE IN A TRENCH, 36" - 40" DEEP UNTIL IT ENTERS THE WATER, AND AT THAT POINT IT WILL HAVE A 6" COVER OF EXISTING MATERIAL.



REV.	DATE
ORIGINAL	1/04

UNDERGROUND PRIMARY RADIAL FEED PRIMARY POLE MATERIALS	
OPER. APPROVAL: J.D.	ENG. APPROVAL: J.S.

TRENCH
URD 1W-1